

# SERIE

# Fittings

# F10

Messing blank  
Messing vernickelt  
Edelstahl  
Aluminium

Einsatz	Technische Daten			
<p><b>Fittings</b></p> <p>werden als schraubbare Verbindungselemente zur Adaption von Schlauch- und Rohrverschraubungen eingesetzt.</p>	<b>Werkstoff</b>	<b>Messing vernickelt</b>	<b>Edelstahl</b>	<b>Aluminium</b>
	<b>Gewinde</b>	metrisch, zyl. BSP-Gewinde, zyl. BSP-Gewinde, kon. *NPT-Gewinde (* auf Anfrage)	BSP-Gewinde, kon. *NPT-Gewinde (* auf Anfrage)	metrisch, zyl. BSP-Gewinde, zyl. *NPT-Gewinde (* auf Anfrage)
	<b>Betriebsdruck</b>	schlauch- und temperaturabhängig	schlauch- und temperaturabhängig	schlauch- und temperaturabhängig
	<b>Temperatur</b>	schlauch- und druckabhängig	schlauch- und druckabhängig	schlauch- und druckabhängig
	<b>Medium</b>	Druckluft, Gase, Flüssigkeiten. <b>Chem. Beständigkeit</b> der eingesetzten Materialien beachten.	aggressive Medien wie z.B. Säuren, Laugen und Reinigungsmittel, etc. <b>Chem. Beständigkeit</b> der eingesetzten Materialien beachten.	Druckluft, Gase, Flüssigkeiten. <b>Chem. Beständigkeit</b> der eingesetzten Materialien beachten.
	<b>Einsatzbereich</b>	typische Pneumatik-anwendungen	typische Pneumatik-anwendungen	typische Pneumatik-anwendungen

F10

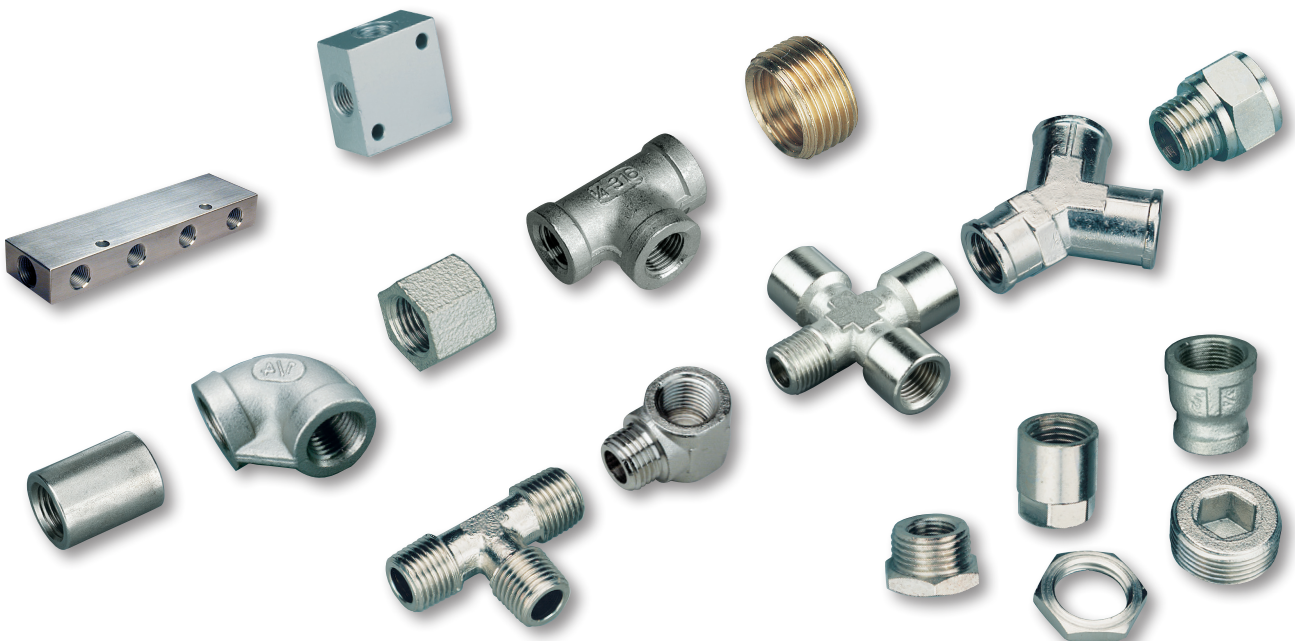

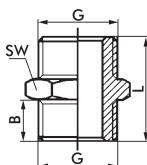

Doppelnippel

Messing vernickelt

Bestell-Nr.	Typ	€/St.	Gew	B	L	SW	VPE
12016002	F-D-M5-MSv		M5	4	11,5	8	10
12017006	F-D-1/8-MSv		G1/8	6	16,5	14	10
12013007	F-D-1/4-MSv		G1/4	8	21,0	17	10
12019008	F-D-3/8-MSv		G3/8	9	23,0	19	10
12015009	F-D-1/2-MSv		G1/2	10	25,5	24	10
12010010	F-D-3/4-MSv		G3/4	11	29,0	26	5
12019011	F-D-1-MSv		G1	15	37,0	36	5
12015012	F-D-1¼-MSv		R1¼	19	45,0	45	5
12017014	F-D-1½-MSv		R1½	24	57,0	54	5
12016016	F-D-2-MSv		R2	26	62,0	67	5

F10

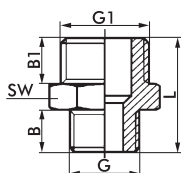

Doppelnippel - reduziert

Messing vernickelt

Bestell-Nr.	Typ	€/St.	Gew	Gew 1	B	B1	L	SW	VPE
12014502	F-Dr-1/8-M5-MSv		M5	1/8"	4	6	14,5	14	10
12012505	F-Dr-1/4-1/8-MSv		G1/8	1/4"	6	8	19,0	17	10
12011507	F-Dr-3/8-1/8-MSv		G1/8	3/8"	6	9	20,0	19	10
12017508	F-Dr-3/8-1/4-MSv		G1/4	3/8"	8	9	22,0	19	10
12017511	F-Dr-1/2-1/4-MSv		G1/4	1/2"	8	10	24,0	24	10
12013512	F-Dr-1/2-3/8-MSv		G3/8	1/2"	9	10	25,0	24	10
12010517	F-Dr-3/4-1/2-MSv		G1/2	3/4"	10	12	27,5	30	5
12017522	F-Dr-1-3/4-MSv		G3/4	1"	15	15	37,5	35	5
12018526	F-Dr-1¼-1-MSv		G1	1¼"	17	17	44,0	45	5
12012531	F-Dr-1½-1¼-MSv		R1¼	1½"	19	19	54,0	54	5
12017539	F-Dr-2-1½-MSv		R1½	2"	22	22	59,0	67	5

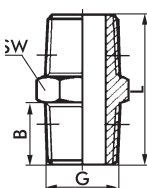

Doppelnippel - konisch

Messing vernickelt

Bestell-Nr.	Typ	€/St.	Gew	B	L	SW	VPE
12022006	F-Dk-1/8-MSv		R1/8	8,0	20,5	12	10
12022007	F-Dk-1/4-MSv		R1/4	11,0	27,0	14	10
12022008	F-Dk-3/8-MSv		R3/8	11,5	28,0	17	10
12024009	F-Dk-1/2-MSv		R1/2	14,0	33,5	22	10

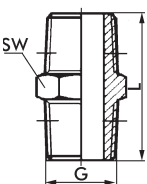

Doppelnippel - konisch



Edelstahl V4A (AISI 316)

Bestell-Nr.	Typ	€/St.	Gew	L	SW	VPE
12050205	FT-DK-1/8-VA		R1/8	10,8	25,0	10
12050206	FT-DK-1/4-VA		R1/4	14,5	30,0	10
12050207	FT-DK-3/8-VA		R3/8	18,0	31,0	10
12050208	FT-DK-1/2-VA		R1/2	22,0	37,0	10
12050209	FT-DK-3/4-VA		R3/4	27,5	40,5	10
12050210	FT-DK-1-VA		R1	34,0	46,0	5
12050211	FT-DK-1 1/4-VA		R1¼	42,0	50,0	1
12050212	FT-DK-1 1/2-VA		R1½	49,0	51,0	1
12050213	FT-DK-2-VA		R2	61,5	61,0	1

## Doppelnippel - reduziert, konisch

Messing vernickelt

Bestell-Nr.	Typ	€/St.	Gew	Gew 1	B	B1	L	SW	VPE
12020501	F-Drk-1/4-1/8-MSv		R1/4	R1/8	7,5	10,5	23,0	14	10
12020502	F-Drk-3/8-1/8-MSv		R3/8	R1/8	8,0	11,5	24,5	17	10
12020503	F-Drk-3/8-1/4-MSv		R3/8	R1/4	11,0	11,5	27,5	17	10
12020504	F-Drk-1/2-1/4-MSv		R1/2	R1/4	11,0	14,0	30,5	22	10
12020505	F-Drk-1/2-3/8-MSv		R1/2	R3/8	11,5	14,0	31,0	22	10

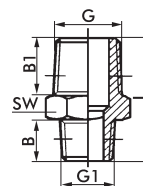

## Doppelnippel - reduziert, konisch



Edelstahl V4A (AISI 316)

Bestell-Nr.	Typ	€/St.	Gew	Gew 1	L	SW	VPE
12050266	FT-Drk-1/4-1/8-VA		R1/4	R1/8	15,0	31,0	10
12050267	FT-Drk-3/8-1/8-VA		R3/8	R1/8	20,0	37,0	10
12050268	FT-Drk-3/8-1/4-VA		R3/8	R1/4	20,0	37,0	10
12050269	FT-Drk-1/2-1/4-VA		R1/2	R1/4	23,0	42,0	10
12050270	FT-Drk-1/2-3/8-VA		R1/2	R3/8	23,0	42,0	10
12050272	FT-Drk-3/4-1/4-VA		R3/4	R1/4	28,0	46,4	5
12050273	FT-Drk-3/4-3/8-VA		R3/4	R3/8	28,0	46,4	5
12050274	FT-Drk-3/4-1/2-VA		R3/4	R1/2	28,0	46,4	5
12050275	FT-Drk-1-1/4-VA		R1	R1/4	35,0	50,5	5
12050276	FT-Drk-1-3/8-VA		R1	R1/4	35,0	50,5	5
12050277	FT-Drk-1-1/2-VA		R1	R1/2	35,0	50,5	5
12050278	FT-Drk-1-3/4-VA		R1	R3/4	35,0	50,5	5
12050279	FT-Drk-1 1/4-3/4-VA		R1½	R3/4	45,0	51,0	5
12050280	FT-Drk-1 1/4-1-VA		R1½	R1	45,0	51,0	5
12050281	FT-Drk-1 1/2-1-VA		R1½	R1	50,0	58,0	5
12050282	FT-Drk-1 1/2-1 1/4-VA		R1½	R1¼	50,0	58,0	1
12050283	FT-Drk-2-1-VA		R2	R1	62,0	61,1	1
12050284	FT-Drk-2-1 1/4-VA		R2	R1¼	62,0	61,1	1
12050285	FT-Drk-2-1 1/2-VA		R2	R1½	62,0	61,1	1

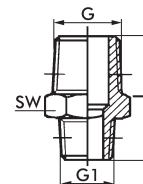

F10

## Doppelnippel - lösbar, Innengewinde



Edelstahl V4A (AISI 316)

Bestell-Nr.	Typ	€/St.	Gew	L	SW	VPE
12050100	FT-DLÖ-II-1/8-VA		G1/8	30,0	26,5	10
12050101	FT-DLÖ-II-1/4-VA		G1/4	30,0	26,5	10
12050102	FT-DLÖ-II-3/8-VA		G3/8	32,5	31,0	10
12050103	FT-DLÖ-II-1/2-VA		G1/2	38,0	37,5	10
12050104	FT-DLÖ-II-3/4-VA		G3/4	40,0	44,5	5
12050105	FT-DLÖ-II-1-VA		G1	49,0	53,5	5
12050106	FT-DLÖ-II-1 1/4-VA		G1¼	50,0	63,0	1
12050107	FT-DLÖ-II-1 1/2-VA		G1½	56,0	71,5	1
12050108	FT-DLÖ-II-2-VA		G2	62,0	85,5	1

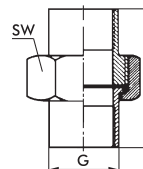

## Doppelnippel - lösbar, konisch, Außengewinde

Messing vernickelt

Bestell-Nr.	Typ	€/St.	Gew	B	L	SW	SW1	VPE
12116556	F-DLÖk-AA-1/8-MSv		R1/8	9,5	28	15	5	10
12112557	F-DLÖk-AA-1/4-MSv		R1/4	12,0	34	19	6	10
12118558	F-DLÖk-AA-3/8-MSv		R3/8	13,0	36	22	8	10
12114559	F-DLÖk-AA-1/2-MSv		R1/2	14,0	40	27	12	10

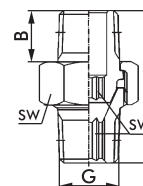

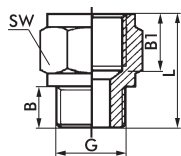

## Doppelnippel - Außen-/Innengewinde

Messing vernickelt

Bestell-Nr.	Typ	€/St.	Gew	B	B1	L	SW	VPE
12140002	F-DAI-M5-MSv		M5	4	4,0	11,0	8	10
12148003	F-DAI-1/8-MSv		G1/8	6	8,0	16,0	14	10
12143006	F-DAI-1/4-MSv		G1/4	8	11,0	22,0	17	10
12141009	F-DAI-3/8-MSv		G3/8	9	11,5	23,5	22	10
12147013	F-DAI-1/2-MSv		G1/2	10	14,0	28,0	26	10

F10

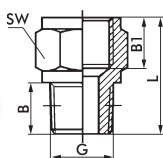

## Doppelnippel - Außen-/Innengewinde, konisch

Messing vernickelt

Bestell-Nr.	Typ	€/St.	Gew	B	B1	L	SW	VPE
12140520	F-DAIk-1/8-MSv		R1/8	8,0	8,0	18,0	14	10
12140521	F-DAIk-1/4-MSv		R1/4	11,0	11,0	24,5	17	10
12140522	F-DAIk-3/8-MSv		R3/8	11,5	11,5	26,0	22	10
12140523	F-DAIk-1/2-MSv		R1/2	14,0	14,0	32,0	26	10

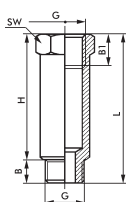

## Doppelnippel - Außen-/Innengewinde, verlängert

Messing vernickelt

Bestell-Nr.	Typ	€/St.	Gew	B	B1	H	L	SW	VPE
12140531	F-DAIr-V16-1/8-MSv		G1/8	6	9	16	22	14	10
12140533	F-DAIr-V36-1/8-MSv		G1/8	7	9	36	43	14	10
12140534	F-DAIr-V45-1/8-MSv		G1/8	6	9	45	51	14	10
12140532	F-DAIr-V27-1/4-MSv		G1/4	9	11	27	35	17	10
12146534	F-DAIr-V43-1/4-MSv		G1/4	8	11	43	51	17	10

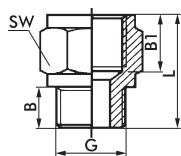

## Doppelnippel - Außen-/Innengewinde, reduziert

Messing vernickelt

Bestell-Nr.	Typ	€/St.	Gew	Gew 1	B	B1	L	SW	VPE
12141102	F-DAIr-M5-1/8-MSv		M5	G1/8	4	6	14,5	14	10
12149105	F-DAIr-1/8-1/4-MSv		G1/8	G1/4	6	8	19,0	17	10
12140106	F-DAIr-1/8-3/8-MSv		G1/8	G3/8	6	9	20,0	19	10
12144108	F-DAIr-1/4-3/8-MSv		G1/4	G3/8	8	9	22,0	19	10
12144111	F-DAIr-1/4-1/2-MSv		G1/4	G1/2	8	10	26,0	24	10
12140112	F-DAIr-3/8-1/2-MSv		G3/8	G1/2	9	10	26,0	24	10
12140113	F-DAIr-1/2-3/4-MSv		G1/2	G3/4	10	11	27,5	30	5

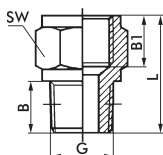

## Doppelnippel - reduziert, konisch, Außen-/Innengewinde

Messing vernickelt

Bestell-Nr.	Typ	€/St.	Gew	Gew 1	B	B1	L	SW	VPE
12140200	F-DAIrK-1/8-1/4-MSv		R1/8	R1/4	8,0	12,0	22,5	17	10
12140201	F-DAIrK-1/8-3/8-MSv		R1/8	R3/8	8,0	12,0	23,0	22	10
12140202	F-DAIrK-1/4-3/8-MSv		R1/4	R3/8	11,0	12,0	26,0	22	10
12140203	F-DAIrK-1/4-1/2-MSv		R1/4	R1/2	11,0	11,5	25,5	22	10
12140204	F-DAIrK-3/8-1/2-MSv		R3/8	R1/2	11,5	14,0	29,5	24	10

## Muffe

Messing vernickelt

Bestell-Nr.	Typ	€/St.	Gew	L	SW	VPE
12179002	F-M-M5-MSv		M5	11,0	8	10
12170006	F-M-1/8-MSV		G1/8	15,0	14	10
12176007	F-M-1/4-MSv		G1/4	22,0	17	10
12172008	F-M-3/8-MSv		G3/8	23,0	22	10
12178009	F-M-1/2-MSv		G1/2	28,0	26	10
12173010	F-M-3/4-MSv		G3/4	34,0	-	5
12172011	F-M-1-MSv		G1	42,5	-	5
12178012	F-M-1¼-MSv		G1¼	44,5	-	5
12170015	F-M-1½-MSv		G1½	51,5	-	5
12179016	F-M-2-MSv		G2	62,5	-	5

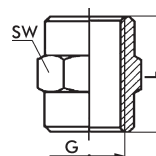

bis 1/2"



ab 3/4"



## Muffe



Edelstahl  
V4A (AISI 316)

Bestell-Nr.	Typ	€/St.	Gew	øD	L	VPE
12050220	FT-M-1/8-VA		G1/8	18,5	23,5	10
12050221	FT-M-1/4-VA		G1/4	18,5	23,5	10
12050222	FT-M-3/8-VA		G3/8	22,0	25,5	10
12050223	FT-M-1/2-VA		G1/2	26,0	31,5	10
12050224	FT-M-3/4-VA		G3/4	31,5	34,5	10
12050225	FT-M-1-VA		G1	40,0	40,0	5
12050226	FT-M-1 1/4-VA		G1¼	48,5	44,0	5
12050227	FT-M-1 1/2-VA		G1½	54,5	44,0	1
12050228	FT-M-2-VA		G2	65,5	53,0	1

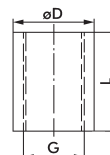

F10



## Muffe - reduziert

Messing vernickelt

Bestell-Nr.	Typ	€/Stck	Gew	Gew 2	L	SW	VPE
12177502	F-Mr-1/8-M5-MSv		M5	G1/8	13,5	14	10
12175505	F-Mr-1/4-1/8-MSv		G1/8	G1/4	19,0	17	10
12174507	F-Mr-3/8-1/8-MSv		G1/8	G3/8	20,0	22	10
12170508	F-Mr-3/8-1/4-MSv		G1/4	G3/8	22,5	22	10
12170511	F-Mr-1/2-1/4-MSv		G1/4	G1/2	25,5	24	10
12176512	F-Mr-1/2-3/8-MSv		G3/8	G1/2	26,0	24	10
12173517	F-Mr-3/4-1/2-MSv		G1/2	G3/4	30,0	-	5
12170522	F-Mr-1-3/4-MSv		G3/4	G1	39,0	-	5

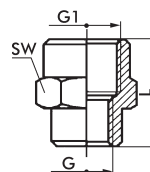

## Muffe - reduziert



Edelstahl  
V4A (AISI 316)

Bestell-Nr.	Typ	€/St.	Gew 1	Gew	L	VPE	
12050320	FT-Mr-1/4-1/8-VA		G1/4	G1/8	18,5	25,5	10
12050321	FT-Mr-3/8-1/8-VA		G3/8	G1/8	22,0	29,0	10
12050322	FT-Mr-3/8-1/4-VA		G3/8	G1/4	22,0	29,0	10
12050323	FT-Mr-1/2-1/4-VA		G1/2	G1/4	26,0	31,0	10
12050324	FT-Mr-1/2-3/8-VA		G1/2	G3/8	26,0	31,0	10
12050325	FT-Mr-3/4-1/4-VA		G3/4	G1/4	31,5	33,5	5
12050326	FT-Mr-3/4-3/8-VA		G3/4	G3/8	31,5	33,5	5
12050327	FT-Mr-3/4-1/2-VA		G3/4	G1/2	31,5	33,5	5
12050328	FT-Mr-1-1/4-VA		G1	G1/4	40,0	38,0	5
12050329	FT-Mr-1-3/8-VA		G1	G3/8	40,0	38,0	5
12050330	FT-Mr-1-1/2-VA		G1	G1/2	40,0	38,0	5
12050331	FT-Mr-1-3/4-VA		G1	G3/4	40,0	38,0	5
12050332	FT-Mr-1 ¼-1/2-VA		G1 1/4	G1/2	48,5	41,0	1
12050333	FT-Mr-1 ¼-3/4-VA		G1 1/4	G3/4	48,5	41,0	1
12050334	FT-Mr-1 ¼-1-VA		G1 1/4	G1	48,5	41,0	1
12050335	FT-Mr-1 ½-3/4-VA		G1 1/2	G3/4	54,5	45,5	1
12050336	FT-Mr-1 ½-1-VA		G1 1/2	G1	54,5	45,5	1
12050337	FT-Mr-1 ½-1 ¼-VA		G1 1/2	G1 1/4	54,5	45,5	1
12050338	FT-Mr-2-1-VA		G2	G1	65,5	49,0	1
12050339	FT-Mr-2-1 ¼-VA		G2	G1 1/4	65,5	49,0	1
12050340	FT-Mr-2-1 ½-VA		G2	G1 1/2	65,5	49,0	1

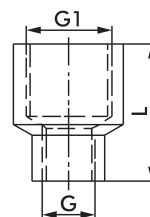

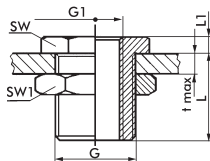

## Muffe - Schott

Messing vernickelt

Bestell-Nr.	Typ	€/St.	Gew	Gew 1	L	L1	t-max mm	SW	SW1	VPE
12170600	F-MS-M5-MSv		M10x1	M5	10,5	3,5	7,0	14	14	10
12170601	F-MS-1/8-MSv		M16x1,5	G1/8	14,0	4,0	10	19	22	10
12170602	F-MS-1/4-MSv		M20x1,5	G1/4	21,0	4,0	16	24	27	10
12170603	F-MS-3/8-MSv		M26x1,5	G3/8	21,0	5,0	15	30	32	10
12170604	F-MS-1/2-MSv		M28x1,5	G1/2	27,0	6,0	21	32	36	5

# F10

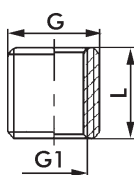

## Reduziernippel - ohne Sechskant

Messing

Bestell-Nr.	Typ	€/St.	Gew	Gew 1	L	VPE
12271505	F-ROS-1/4-1/8-MS		G1/4	1/8"	8	10
12276508	F-ROS-3/8-1/4-MS		G3/8	1/4"	9	10
12272512	F-ROS-1/2-3/8-MS		G1/2	3/8"	10	10
12276511	F-ROS-3/4-1/2-MS		G3/4	1/2"	14	5
12273513	F-ROS-1-3/4-MS		G1	3/4"	20	5

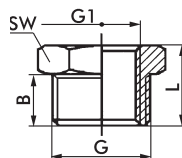

## Reduziernippel

Messing vernickelt

Bestell-Nr.	Typ	€/St.	Gew	Gew 1	B	L	SW	VPE
12257002	F-R-1/8-M5-MSv		G1/8	M5	6	10,5	14	10
12255005	F-R-1/4-1/8-MSv		G1/4	G1/8	8	13,0	17	10
12254007	F-R-3/8-1/8-MSv		G3/8	G1/8	9	14,0	19	10
12250008	F-R-3/8-1/4-MSv		G3/8	G1/4	9	14,0	19	10
12250010	F-R-1/2-1/8-MSv		G1/2	G1/8	10	15,5	24	10
12250011	F-R-1/2-1/4-MSv		G1/2	G1/4	10	15,5	24	10
12256012	F-R-1/2-3/8-MSv		G1/2	G3/8	10	15,5	24	10
12254015	F-R-3/4-1/4-MSv		G3/4	G1/4	10	16,0	30	5
12257016	F-R-3/4-3/8-MSv		G3/4	G3/8	11	18,0	30	5
12253017	F-R-3/4-1/2-MSv		G3/4	G1/2	11	17,5	30	5
12255020	F-R-1-3/8-MSv		G1	G3/8	11	20,5	35	5
12254021	F-R-1-1/2-MSv		G1	G1/2	14	21,5	35	5
12250022	F-R-1-3/4-MSv		G1	G3/4	12	21,5	35	5
12258025	F-R-1 1/4-3/4-MSv		R1 1/4	R3/4	17	28,5	48	5
12251026	F-R-1 1/4-1-MSv		R1 1/4	R1	12	26,0	42	5
12259029	F-R-1 1/2-3/4-MSv		R1 1/2	R3/4	22	34,5	54	5
12256030	F-R-1 1/2-1-MSv		R1 1/2	R1	13	25,0	48	5
12250024	F-R-1 1/2-1 1/4-MSv		R1 1/2	R1 1/4	22	35,5	54	5
12250039	F-R-2-1 1/2-MSv		R2	R1 1/2	23	35,5	66	5

Ab 1 1/4" Außengewinde konisch !

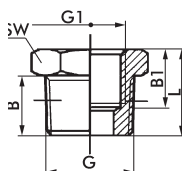

## Reduziernippel - konisch

Messing vernickelt

Bestell-Nr.	Typ	€/St.	Gew	Gew 1	B	B1	L	SW	VPE
12250101	F-Rk-1/4-1/8-MSv		R1/4	R1/8	11,0	8,0	16,0	14	10
12250102	F-Rk-3/8-1/8-MSv		R3/8	R1/8	11,5	8,0	16,5	17	10
12250103	F-Rk-3/8-1/4-MSv		R3/8	R1/4	11,5	11,0	16,5	17	10
12250104	F-Rk-1/2-1/8-MSv		R1/2	R1/8	14,0	8,0	19,5	22	10
12250662	F-Rk-1/2-1/4-MSv		R1/2	R1/4	14,0	11,0	19,5	22	10
12250105	F-Rk-1/2-3/8-MSv		R1/2	R3/8	14,0	11,5	19,5	22	10

## Reduziernippel - konisch



Edelstahl  
V4A (AISI 316)

Bestell-Nr.	Typ	€/St.	Gew	Gew 1	L	SW	VPE
12050290	FT-Rk-1/4-1/8-VA		R1/4	R1/8	14,5	17,0	10
12050291	FT-Rk-3/8-1/8-VA		R3/8	R1/8	18,0	18,0	10
12050292	FT-Rk-3/8-1/4-VA		R3/8	R1/4	18,0	18,0	10
12050293	FT-Rk-1/2-1/8-VA		R1/2	R1/8	22,0	22,0	10
12050294	FT-Rk-1/2-1/4-VA		R1/2	R1/4	22,0	22,0	10
12050295	FT-Rk-1/2-3/8-VA		R1/2	R1/4	22,0	22,0	10
12050296	FT-Rk-3/4-1/4-VA		R3/4	R1/4	27,5	25,0	5
12050297	FT-Rk-3/4-3/8-VA		R3/4	R3/8	27,5	25,0	5
12050298	FT-Rk-3/4-1/2-VA		R3/4	R1/2	27,5	25,0	5
12050299	FT-Rk-1-1/4-VA		R1	R1/4	34,0	28,0	5
12050300	FT-Rk-1-3/8-VA		R1	R3/8	34,0	28,0	5
12050301	FT-Rk-1-1/2-VA		R1	R1/2	34,0	28,0	5
12050302	FT-Rk-1-3/4-VA		R1	R3/4	34,0	28,0	5
12050303	FT-Rk-1 1/4-1/2-VA		R1¼	R1/2	43,5	30,5	1
12050304	FT-Rk-1 1/4-3/4-VA		R1¼	R3/4	43,5	30,5	1
12050305	FT-Rk-1 1/4-1-VA		R1¼	R1	43,5	30,5	1
12050308	FT-Rk-1 1/2-1-VA		R1½	R1	49,0	33,0	1
12050309	FT-Rk-1 1/2-1 1/4-VA		R1½	R1¼	49,0	33,0	1
12050312	FT-Rk-2-1-VA		R2	R1	61,5	37,0	1
12050313	FT-Rk-2-1 1/4-VA		R2	R1¼	61,5	37,0	1
12050314	FT-Rk-2-1 1/2-VA		R2	R1½	61,5	37,0	1

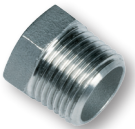
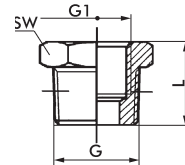

F10

## Winkelstück - konisch, Außengewinde

Messing vernickelt

Bestell-Nr.	Typ	€/St.	Gew	B	L	L1	VPE
12340505	F-Wk-M5-MSv		M5	4,0	11,0	11,0	10
12343506	F-Wk-1/8-MSv		R1/8	8,0	19,0	19,0	10
12349507	F-Wk-1/4-MSv		R1/4	11,0	24,0	24,0	10
12345508	F-Wk-3/8-MSv		R3/8	11,5	26,0	26,0	10
12341509	F-Wk-1/2-MSv		R1/2	14,0	31,5	31,5	5

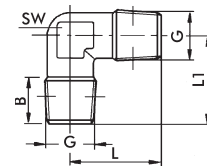

## Winkelstück - einschraubbar, konisch

Messing vernickelt

Bestell-Nr.	Typ	€/St.	Gew	B	B1	L	L1	VPE
12360005	F-WEK-M5-MSv		M5	4,0	4,0	11,0	11,5	10
12361506	F-WEK-1/8-MSv		R1/8	8,0	8,0	21,0	18,5	10
12367507	F-WEK-1/4-MSv		R1/4	11,0	11,0	26,5	25,0	10
12363508	F-WEK-3/8-MSv		R3/8	11,5	11,5	28,0	26,0	10
12369509	F-WEK-1/2-MSv		R1/2	14,0	14,0	33,5	31,0	5
12360110	F-WEK-3/4-MSv		R3/4	13,0	13,0	25,0	40,0	5
12360111	F-WEK-1-MSv		R1	18,0	18,0	35,0	52,0	5
12360112	F-WEK-1¼-MSv		R1¼	22,0	18,0	41,0	58,0	5
12360013	F-WEK-1½-MSv		R1½	23,0	20,0	45,0	64,5	5
12360114	F-WEK-2-MSv		R2	25,0	25,0	55,0	69,0	5

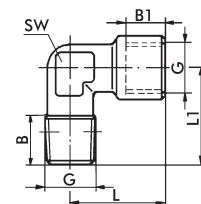

bis 1/2"



ab 3/4"



## Winkelstück - einschraubbar, konisch



Edelstahl  
V4A (AISI 316)

Bestell-Nr.	Typ	€/St.	Gew	L	L1	VPE
12050145	FT-WEK-1/8-VA		R1/8	17,0	26,0	10
12050146	FT-WEK-1/4-VA		R1/4	19,0	26,0	10
12050147	FT-WEK-3/8-VA		R3/8	23,0	32,0	10
12050148	FT-WEK-1/2-VA		R1/2	25,0	36,0	5
12050149	FT-WEK-3/4-VA		R3/4	27,5	42,0	5
12050150	FT-WEK-1-VA		R1	33,0	50,0	5
12050151	FT-WEK-1 1/4-VA		R1¼	40,0	56,0	1
12050152	FT-WEK-1 1/2-VA		R1½	43,0	60,0	1
12050153	FT-WEK-2-VA		R2	52,0	75,0	1

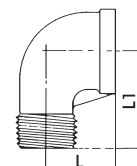

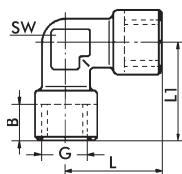

Winkelstück - Innengewinde

Messing vernickelt

Bestell-Nr.	Typ	€/St.	Gew	B	L	L1	VPE
12350005	F-WI-M5-MSv		M5	3,0	11,0	11,0	10
12354006	F-WI-1/8-MSv		G1/8	8,0	21,0	21,0	10
12350007	F-WI-1/4-MSv		G1/4	11,0	25,5	25,5	10
12356008	F-WI-3/8-MSv		G3/8	11,5	28,0	28,0	10
12352009	F-WI-1/2-MSv		G1/2	14,0	33,5	33,5	5
12357010	F-WI-3/4-MSv		G3/4	12,0	26,5	26,5	5
12356011	F-WI-1-MSv		G1	16,0	31,5	31,5	5
12352012	F-WI-1¼-MSv		G1¼	18,0	43,0	43,0	5
12354014	F-WI-1½-MSv		G1½	18,0	46,0	46,0	5
12353016	F-WI-2-MSv		G2	20,0	55,5	55,5	5

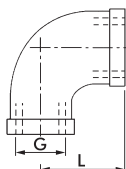

Winkelstück - Innengewinde



Edelstahl V4A (AISI 316)

Bestell-Nr.	Typ	€/St.	Gew	L	VPE
12050130	FT-WI-1/8-VA		G1/8	17,0	10
12050131	FT-WI-1/4-VA		G1/4	19,0	10
12050132	FT-WI-3/8-VA		G3/8	23,0	10
12050133	FT-WI-1/2-VA		G1/2	25,0	5
12050134	FT-WI-3/4-VA		G3/4	27,5	5
12050135	FT-WI-1-VA		G1	33,0	5
12050136	FT-WI-1 1/4-VA		G1¼	40,0	1
12050137	FT-WI-1 1/2-VA		G1½	43,0	1
12050138	FT-WI-2-VA		G2	52,0	1

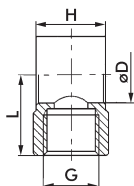

Winkelschwenkringstück - Innengewinde

Messing vernickelt

Bestell-Nr.	Typ	€/St.	Gew	øD	H	L	VPE
12676002	F-WSI-M5-MSv		M5	5,1	9,0	10,5	10
12677006	F-WSI-1/8-MSv		G1/8	10,0	14,5	16,0	10
12673007	F-WSI-1/4-MSv		G1/4	13,0	14,5	22,0	10

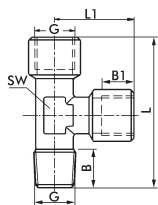

L-Stück - einschraubbar, konisch

Messing vernickelt

Bestell-Nr.	Typ	€/St.	Gew	B	B1	L	L1	VPE
12420505	F-LEk-M5-MSv		M5	4,0	4,0	23,0	11,0	10
12421506	F-LEk-1/8-MSv		R1/8	8,0	8,0	39,5	18,5	10
12427507	F-LEk-1/4-MSv		R1/4	11,0	11,0	49,0	23,5	10
12423508	F-LEk-3/8-MSv		R3/8	11,5	11,5	54,0	26,0	10
12429509	F-LEk-1/2-MSv		R1/2	14,0	14,0	64,5	31,0	5

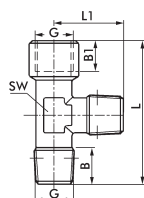

L-Stück - aufschraubbar, konisch

Messing vernickelt

Bestell-Nr.	Typ	€/St.	Gew	B	B1	L	L1	VPE
12430506	F-LAk-1/8-MSv		R1/8	8,0	8,0	38,0	19,5	10
12436507	F-LAk-1/4-MSv		R1/4	11,0	11,0	50,5	24,8	10
12432508	F-LAk-3/8-MSv		R3/8	11,5	13,0	59,0	28,5	10
12438509	F-LAk-1/2-MSv		R1/2	14,0	14,0	64,8	31,8	5



## L-Stück - einschraubbar, Vierkant

Messing vernickelt

Bestell-Nr.	Typ	€/St.	Gew	B	B1	H	L	VPE
12440002	F-LEV-M5-MSv		M5	4	4	9	9	10
12441006	F-LEV-1/8-MSv		G1/8	7	8	13	13	10
12447007	F-LEV-1/4-MSv		G1/4	8	9	18	18	10

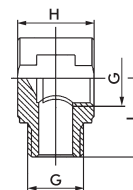

## T-Stück - konisch, Außengewinde

Messing vernickelt

Bestell-Nr.	Typ	€/St.	Gew	B	L	L1	VPE
12509506	F-Tk-1/8-MSv		R1/8	8,0	37	18,5	10
12505507	F-Tk-1/4-MSv		R1/4	11,0	49,5	24,75	10
12501508	F-Tk-3/8-MSv		R3/8	11,5	57	28,5	10
12507509	F-Tk-1/2-MSv		R1/2	14,0	63,5	31,75	5

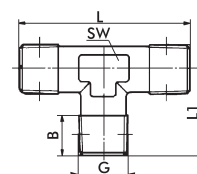

F10

## T-Stück - Innengewinde

Messing vernickelt

Bestell-Nr.	Typ	€/St.	Gew	B	L	L1	VPE
12510005	F-TI-M5-MSv		M5	4,0	22	11,0	10
12510006	F-TI-1/8-MSv		G1/8	8,0	39	21,0	10
12516007	F-TI-1/4-MSv		G1/4	11,0	51	25,5	10
12512008	F-TI-3/8-MSv		G3/8	11,5	56	28,0	10
12518009	F-TI-1/2-MSv		G1/2	14,0	67	33,5	5
12513010	F-TI-3/4-MSv		G3/4	12,0	52	25,5	5
12512011	F-TI-1-MSv		G1	15,0	63	31,5	5
12518012	F-TI-1¼-MSv		G1¼	18,0	86	42,0	5
12510014	F-TI-1½-MSv		G1½	20,0	96	47,0	5
12519016	F-TI-2-MSv		G2	25,0	116	57,5	5

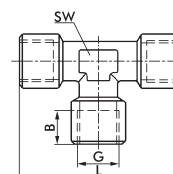

## T-Stück - Innengewinde



Edelstahl  
V4A (AISI 316)

Bestell-Nr.	Typ	€/St.	Gew	L	L1	VPE
12050160	FT-TI-1/8-VA		G1/8	17,0		10
12050161	FT-TI-1/4-VA		G1/4	19,0		10
12050162	FT-TI-3/8-VA		G3/8	23,0		10
12050163	FT-TI-1/2-VA		G1/2	25,0		10
12050164	FT-TI-3/4-VA		G3/4	27,5		5
12050165	FT-TI-1-VA		G1	33,0		5
12050166	FT-TI-1 1/4-VA		G1¼	40,0		5
12050167	FT-TI-1 1/2-VA		G1½	43,0		5
12050168	FT-TI-2-VA		G2	52,0		1

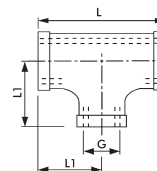

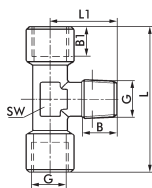

## T-Stück - einschraubbar, konisch

Messing vernickelt

Bestell-Nr.	Typ	€/St.	Gew	B	B1	L	L1	VPE
12520505	F-TEK-M5-MSv		M5	4,0	4,0	22	11,5	10
12527506	F-TEK-1/8-MSv		R1/8	8,0	8,0	42	18,5	10
12523507	F-TEK-1/4-MSv		R1/4	11,0	11,0	51	23,5	10
12529508	F-TEK-3/8-MSv		R3/8	11,5	11,5	56	26,0	10
12525509	F-TEK-1/2-MSv		R1/2	14,0	14,0	67	31,0	5
12525510	F-TEK-3/4-MSv		R3/4	14,5	16,5	73	32,0	5
12524403	F-TEK-1-MSv		R1	16,8	19,0	90	39,0	5

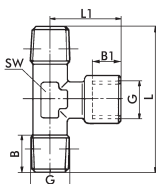

## T-Stück - aufschraubbar, konisch

Messing vernickelt

Bestell-Nr.	Typ	€/St.	Gew	B	B1	L	L1	VPE
12545506	F-TAK-1/8-MSv		R1/8	8,0	8,0	37	20,5	10
12541507	F-TAK-1/4-MSv		R1/4	11,0	11,0	49,6	25,8	10
12547508	F-TAK-3/8-MSv		R3/8	11,5	11,5	57	28,5	10
12543509	F-TAK-1/2-MSv		R1/2	14,0	14,0	63,6	34,8	5

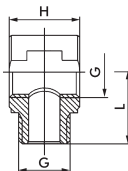

## T-Stück - einschraubbar, Vierkant

Messing vernickelt

Bestell-Nr.	Typ	€/St.	Gew	B	H	L	VPE
12537002	F-TEV-M5-MSv		M5	4	9	9	10
12538006	F-TEV-1/8-MSv		G1/8	7	13	13	10
12534007	F-TEV-1/4-MSv		G1/4	8	18	18	10

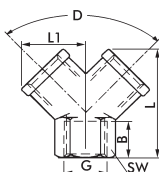

## Y-Stück - Innengewinde

Messing vernickelt

Bestell-Nr.	Typ	€/St.	Gew	B	L	L1	D	SW	VPE
12604042	F-YI-1/8-MSv		G1/8	8,0	26,5	14,5	90°	13	10
12600043	F-YI-1/4-MSv		G1/4	11,0	32,0	18,0	90°	17	10
12606044	F-YI-3/8-MSv		G3/8	11,5	37,0	20,5	90°	20	10
12602045	F-YI-1/2-MSv		G1/2	14,0	44,0	26,5	90°	25	10

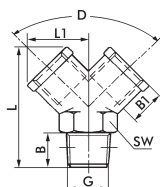

## Y-Stück - einschraubbar, konisch

Messing vernickelt

Bestell-Nr.	Typ	€/St.	Gew	B	B1	L	L1	D	SW	VPE
12600601	F-YEK-1/8-MSv		R1/8	8,0	8,0	32,0	14,5	90°	13	10
12600602	F-YEK-1/4-MSv		R1/4	11,0	11,0	38,0	18,0	90°	17	10
12600603	F-YEK-3/8-MSv		R3/8	11,5	11,5	42,5	20,5	90°	20	10
12600604	F-YEK-1/2-MSv		R1/2	14,0	14,0	53,0	26,5	90°	25	5

## Wanddose - Innengewinde

Messing vernickelt

Bestell-Nr.	Typ	€/St.	Gew	L1	L2	VPE
12360100	F-WD-1/2-MSv		1/2	27	40,5	1

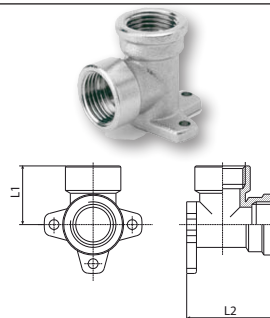

## Kreuz-Stück - einschraubbar, konisch

Messing vernickelt

Bestell-Nr.	Typ	€/St.	Gew	B	B1	L	L1	VPE
12680801	F-KEK-1/8-MSv		R1/8	8,0	8,0	42	39,5	5
12680802	F-KEK-1/4-MSv		R1/4	11,0	11,0	51	49,0	5
12680803	F-KEK-3/8-MSv		R3/8	11,5	11,5	56	54,0	5
12680804	F-KEK-1/2-MSv		R1/2	14,0	14,0	67	64,5	5

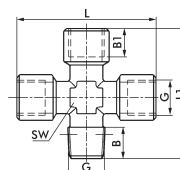

F10

## Kreuz-Stück - Innengewinde

Messing vernickelt

Bestell-Nr.	Typ	€/St.	Gew	B	L1	VPE
12686006	F-KI-1/8-MSv		G1/8	8,0	42	5
12682007	F-KI-1/4-MSv		G1/4	11,0	51	5
12688008	F-KI-3/8-MSv		G3/8	11,5	56	5
12684009	F-KI-1/2-MSv		G1/2	14,0	67	5

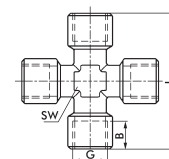

## Kreuz-Stück - Innengewinde



Edelstahl V4A (AISI 316)

Bestell-Nr.	Typ	€/St.	Gew	L	VPE
12050190	FT-KI-1/8-VA		G1/8	17,0	5
12050191	FT-KI-1/4-VA		G1/4	19,0	5
12050192	FT-KI-3/8-VA		G3/8	23,0	5
12050193	FT-KI-1/2-VA		G1/2	25,0	5
12050194	FT-KI-3/4-VA		G3/4	27,5	5
12050195	FT-KI-1-VA		G1	33,0	5
12050196	FT-KI-1 1/4-VA		G1¼	40,0	1
12050197	FT-KI-1 1/2-VA		G1½	43,0	1
12050198	FT-KI-2-VA		G2	52,0	1

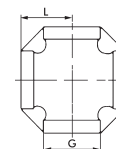

## Kreuz-Stück - Innengewinde, Vierkant

Aluminium natur

Bestell-Nr.	Typ	€/St.	Gew	B	L	L1	H	øD	VPE
12687606	F-KIV-1/8-AL-natur		G1/8	8,0	25	8,5	16	4,5	1
12683607	F-KIV-1/4-AL-natur		G1/4	11,0	40	13,0	20	5,5	1
12689608	F-KIV-3/8-AL-natur		G3/8	11,5	50	17,0	25	5,5	1
12685609	F-KIV-1/2-AL-natur		G1/2	12,0	50	17,0	30	5,5	1

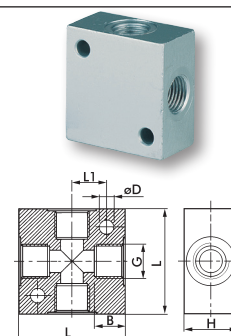

Verteilerblock - Innengewinde - einseitig

Aluminium natur

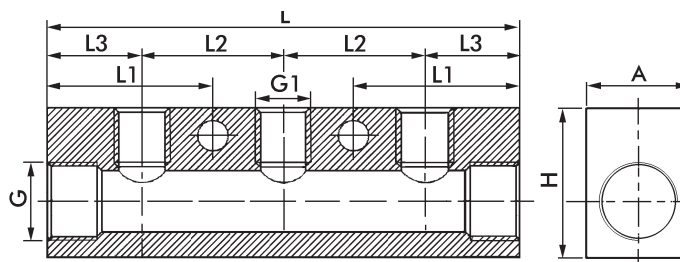

Bestell-Nr.	Typ	€/St.	Gew	Gew 1	L	L1	L2	L3	H	A	VPE
12750501	F-VT1-2x1/4-3x1/8-AL-natur		G1/4	G1/8	90	30	30	15	30	20	5
12750502	F-VT1-2x1/4-4x1/8-AL-natur		G1/4	G1/8	120	30	30	15	30	20	5
12750503	F-VT1-2x1/4-5x1/8-AL-natur		G1/4	G1/8	150	30	30	15	30	20	1
12750505	F-VT1-2x3/8-3x1/4-AL-natur		G3/8	G1/4	108	36	36	18	30	20	1
12750506	F-VT1-2x3/8-4x1/4-AL-natur		G3/8	G1/4	144	36	36	18	30	20	1
12750507	F-VT1-2x3/8-5x1/4-AL-natur		G3/8	G1/4	180	36	36	18	30	20	1

F10

Verteilerblock - Innengewinde - beidseitig

Aluminium natur

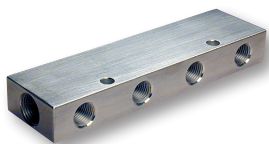
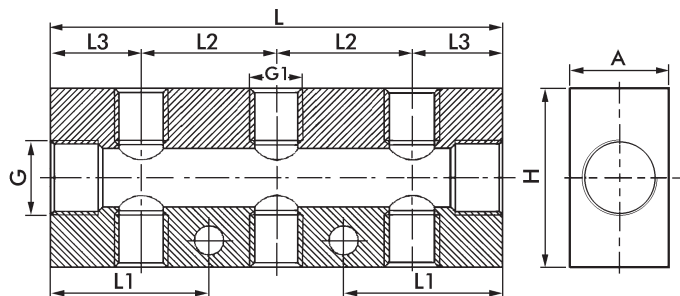

Bestell-Nr.	Typ	€/St.	Gew	Gew 1	L	L1	L2	L3	H	A	VPE
12750509	F-VT2-2x1/4-6x1/8-AL-natur		G1/4	G1/8	90	30	30	15	30	20	1
12750510	F-VT2-2x1/4-8x1/8-AL-natur		G1/4	G1/8	120	30	30	15	30	20	1
12750511	F-VT2-2x1/4-10x1/8-AL-natur		G1/4	G1/8	150	30	30	15	30	20	1
12750513	F-VT2-2x3/8-6x1/4-AL-natur		G3/8	G1/4	108	36	36	18	40	20	5
12750514	F-VT2-2x3/8-8x1/4-AL-natur		G3/8	G1/4	144	36	36	18	40	20	1
12750515	F-VT2-2x3/8-10x1/4-AL-natur		G3/8	G1/4	180	36	36	18	40	20	1
12750516	F-VT2-2x1/2-6x1/4-AL-natur		G1/2	G1/4	116	40	36	22	40	30	1
12750517	F-VT2-2x1/2-8x1/4-AL-natur		G1/2	G1/4	152	40	36	22	40	30	1
12750518	F-VT2-2x1/2-10x1/4-AL-natur		G1/2	G1/4	188	40	36	22	40	30	1

Verteilerblock - Innengewinde - beidseitig

Aluminium natur

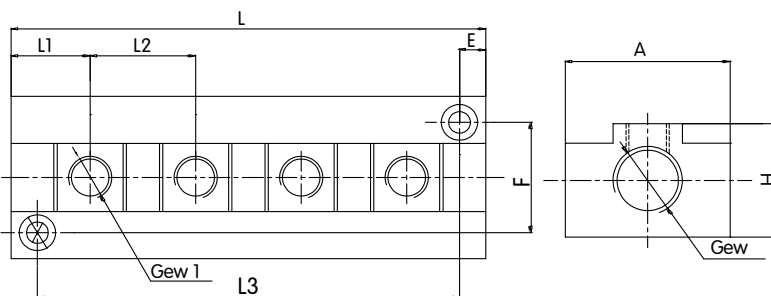

Bestell-Nr.	Typ	€/St.	Gew	Gew 1	A	E	F	H	L	L1	L2	L3	VPE
12750549	F-VTF2-2x1/2-8x1/4-AL-natur		G1/2	G1/4	50	8	34	35	144	24,0	32	128	1
12750550	F-VTF2-2x3/4-8x1/2-AL-natur		G3/4	G1/2	60	10	40	45	170	31,0	36	150	1
12750533	F-VTF2-2x3/8-8x1/8-AL-natur		G3/8	G1/8	40	7	26	30	114	22,5	23	100	1

## Verschluss-Schraube - Innensechskant mit O-Ring-Abdichtung

Messing vernickelt

Bestell-Nr.	Typ	€/St.	Gew	B	L	øD	SW	VPE
12772002	F-VIS-M5-MSv		M5	4	7,5	8	2,5	10
12773006	F-VIS-1/8-MSv		G1/8	6	8,5	14	5,0	10
12779007	F-VIS-1/4-MSv		G1/4	8	11,0	18	6,0	10
12775008	F-VIS-3/8-MSv		G3/8	9	12,5	20	8,0	10
12771009	F-VIS-1/2-MSv		G1/2	10	13,5	25	10,0	10

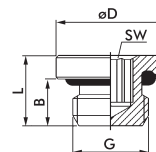

## Verschluss-Schraube - Außensechskant - DIN 910

Messing vernickelt

Bestell-Nr.	Typ	€/St.	Gew	B	L	SW	VPE
12780020	F-VAS-M5-MSv		M5	4	7,5	8	10
12780021	F-VAS-1/8-MSv		G1/8	6	10,5	14	10
12788007	F-VAS-1/4-MSv		G1/4	8	13,0	17	10
12780022	F-VAS-3/8-MSv		G3/8	9	14,0	19	10
12780023	F-VAS-1/2-MSv		G1/2	10	15,5	24	10
12780024	F-VAS-3/4-MSv		G3/4	11	16,0	30	10
12780025	F-VAS-1-MSv		G1	12	17,0	40	5

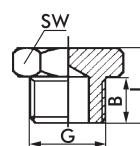

F10

## Verschluss-Schraube - Außensechskant - konisch



Edelstahl V4A (AISI 316)

Bestell-Nr.	Typ	€/St.	Gew	L	SW	VPE
12050250	FT-VASK-1/8-VA		R1/8	12,5	17,5	10
12050251	FT-VASK-1/4-VA		R1/4	15,8	17,5	10
12050252	FT-VASK-3/8-VA		R3/8	18,0	18,5	10
12050253	FT-VASK-1/2-VA		R1/2	22,0	21,5	5
12050254	FT-VASK-3/4-VA		R3/4	27,5	21,5	5
12050255	FT-VASK-1-VA		R1	34,0	27,0	5
12050256	FT-VASK-1 1/4-VA		R1¼	43,5	30,0	5
12050257	FT-VASK-1 1/2-VA		R1½	49,0	30,5	5
12050258	FT-VASK-2-VA		R2	61,5	35,5	1

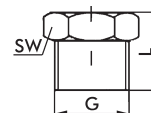

## Verschluss-Schraube ohne Bund - Innensechskant, zylindrisch

Messing vernickelt

Bestell-Nr.	Typ	€/St.	Gew	B	øD	SW	VPE
12800515	F-VOB-1/8-MSv		G1/8	8,0	8,0	5	10
12800516	F-VOB-1/4-MSv		G1/4	11,0	11,0	6	10
12800517	F-VOB-3/8-MSv		G3/8	12,5	14,5	8	10
12800518	F-VOB-1/2-MSv		G1/2	14,0	18,0	10	10

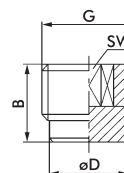

## Verschluss-Schraube ohne Bund - Innensechskant, konisch - DIN 906

Messing vernickelt

Bestell-Nr.	Typ	€/St.	Gew	B	SW	VPE
12800520	F-VOBK-1/8-MSv		R1/8	7,5	5	10
12800521	F-VOBK-1/4-MSv		R1/4	10,0	6	10
12800522	F-VOBK-3/8-MSv		R3/8	11,0	8	10
12800523	F-VOBK-1/2-MSv		R1/2	13,0	10	10

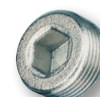
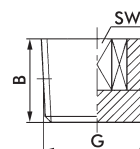

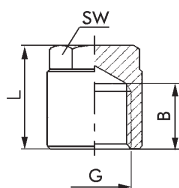

Verschlussmutter

Messing vernickelt

Bestell-Nr.	Typ	€/St.	Gew	B	L	SW	VPE
12815006	F-VM-1/8-MSv		G1/8	7,5	11	12	10
12811007	F-VM-1/4-MSv		G1/4	11,0	19	14	10
12817008	F-VM-3/8-MSv		G3/8	11,5	20	17	10
12813009	F-VM-1/2-MSv		G1/2	14,0	22	19	10
12818010	F-VM-3/4-MSv		G3/4	10,0	14	30	5
12817011	F-VM-1-MSv		G1	12,0	15	38	5
12813012	F-VM-1¼-MSv		G1¼	20,0	25	48	5
12815014	F-VM-1½-MSv		G1½	22,0	26	53	5
12814016	F-VM-2-MSv		G2	25,0	31	66	5

F10

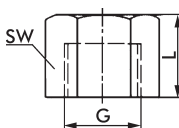
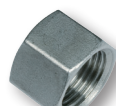

Verschlussmutter



Edelstahl V4A (AISI 316)

Bestell-Nr.	Typ	€/St.	Gew	L	SW	VPE
12050235	FT-VM-1/8-VA		G1/8	14,5	13,0	10
12050236	FT-VM-1/4-VA		G1/4	18,0	14,0	10
12050237	FT-VM-3/8-VA		G3/8	21,0	14,5	10
12050238	FT-VM-1/2-VA		G1/2	25,0	18,5	10
12050239	FT-VM-3/4-VA		G3/4	30,5	19,0	10
12050240	FT-VM-1-VA		G1	37,0	22,0	5
12050241	FT-VM-1 1/4-VA		G1¼	45,5	25,0	1
12050242	FT-VM-1 1/2-VA		G1½	52,5	25,0	1
12050243	FT-VM-2-VA		G2	64,5	30,0	1

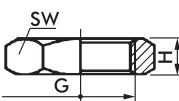
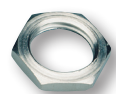

Sechskantmutter - Zollgewinde

Messing vernickelt

Bestell-Nr.	Typ	€/St.	Gew	H	SW	VPE
12824006	F-MU-1/8-MSv		G1/8	4,5	14	10
12820007	F-MU-1/4-MSv		G1/4	5,0	17	10
12826008	F-MU-3/8-MSv		G3/8	5,5	19	10
12822009	F-MU-1/2-MSv		G1/2	6,0	24	10
12820110	F-MU-3/4-MSv		G3/4	5,0	30	10
12820011	F-MU-1-MSv		G1	8,0	38	10